

elvial

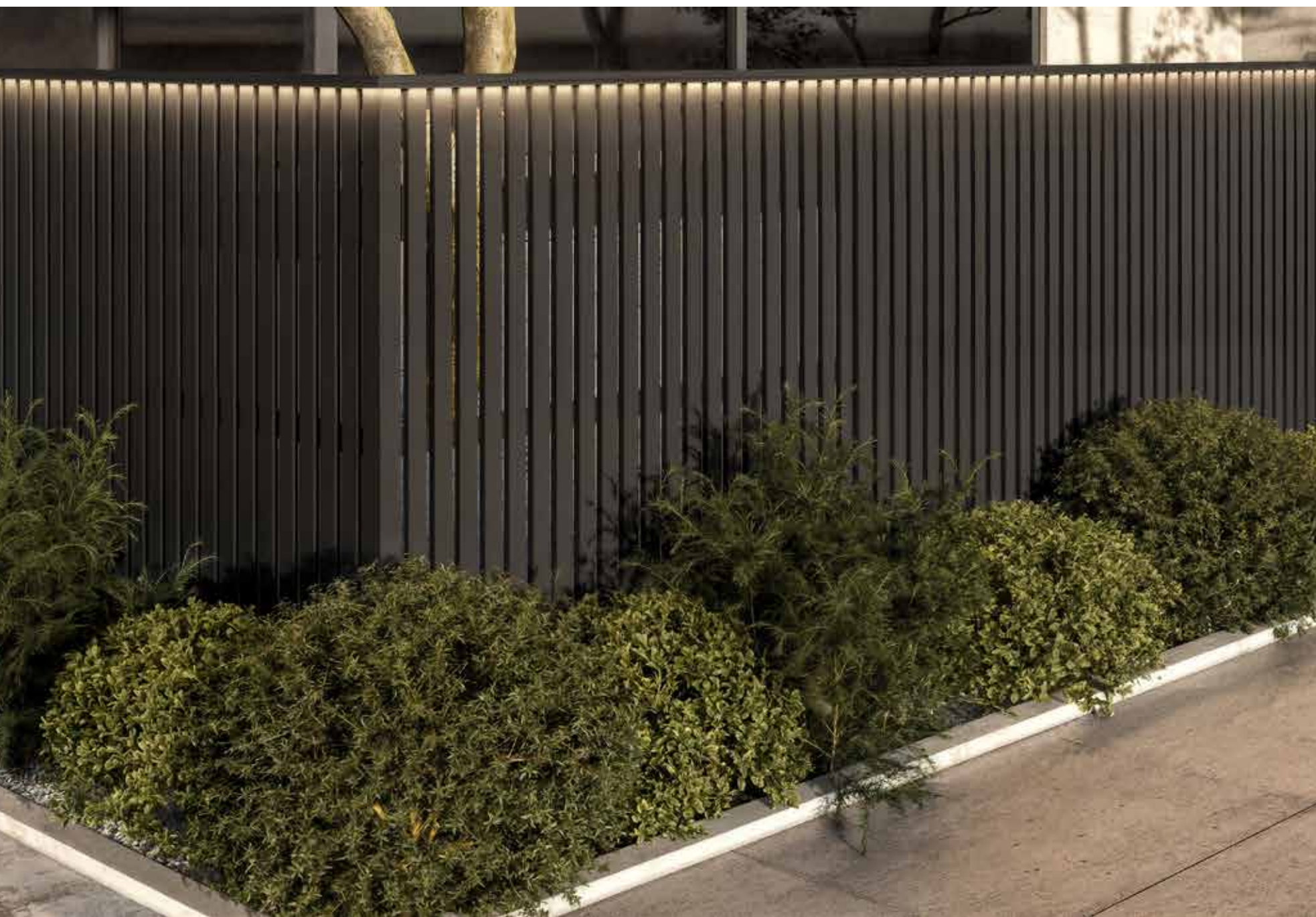

**INNOVATIVE TECHNOLOGIES\_  
ELVIAL PRE-ANODIZING 2IN1\_  
ELVIAL I<sup>2</sup> INSULATION TECHNOLOGY\_  
ELVIAL WINDOW.ID\_  
BE DIFFERENT.**

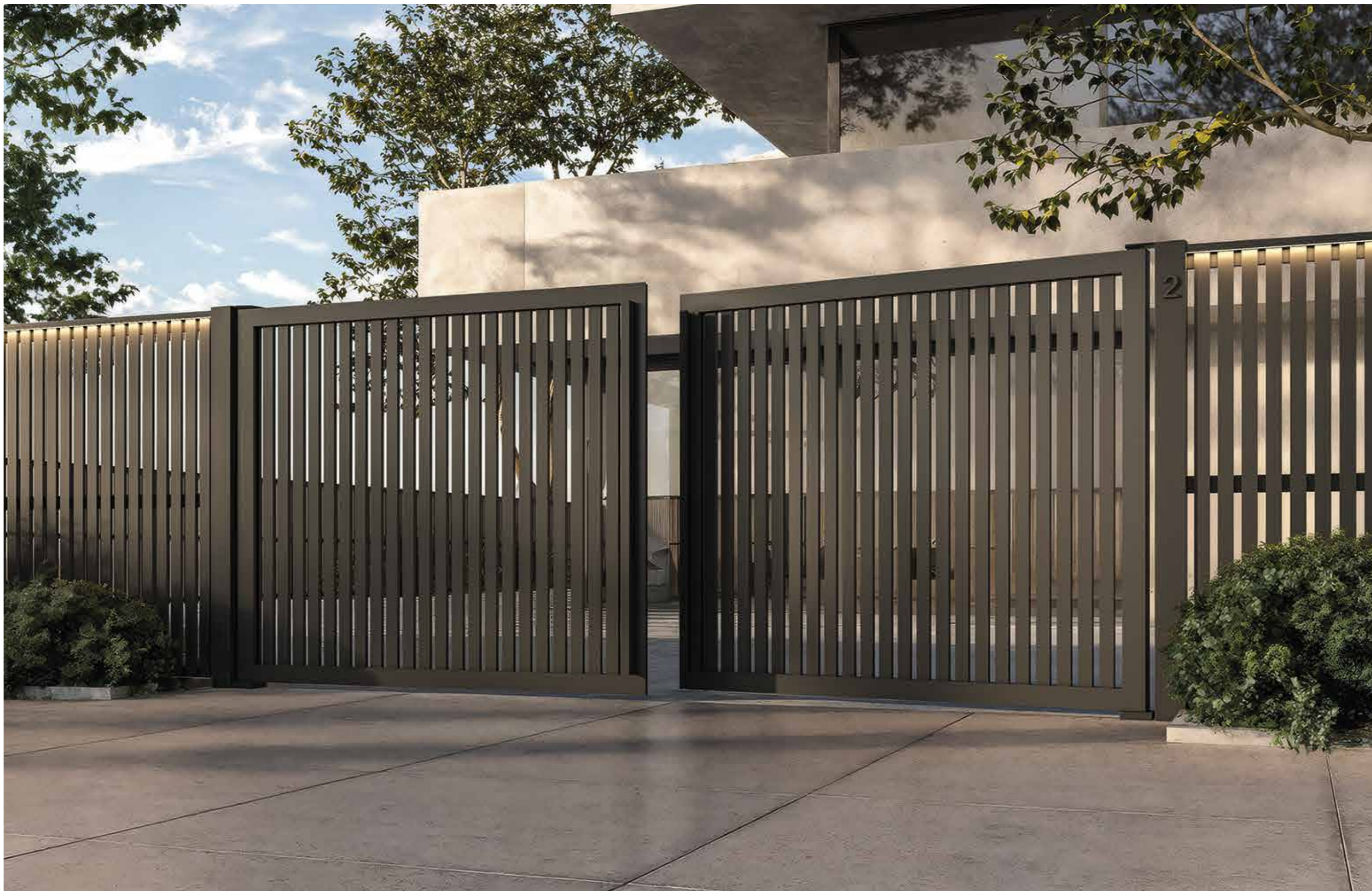

# ELVIAL FENCES

The new ELVIAL fencing system combines contemporary design with high functionality, offering five design options that adapt to any architectural style. Clean, minimal lines, concealed fixing points, the option to integrate LED lighting, and specially designed louvers for complete privacy enhance the aesthetics of any outdoor space.

The ability to install louvers in vertical or horizontal orientation, cover large perimeters, and choose prefabricated frames ensures flexibility and a particularly easy and fast installation. Each design option can be combined with single sash, double sash, opening, or sliding gates, meeting every access and security requirement.



# FENCE 1

## The Identity

Mullion 70mm x 70mm	Hidden screws
Installation louver - louver	Fixing from the inner side for safety
Vertical and horizontal louvers	Pin Ø20
Louvers width 25mm, 20mm and 14mm	Handrail 100mm
With an adaptor, it accepts 3mm metal sheet	Option for LED strip lighting
With an adaptor, it accepts glass with a thickness of 6mm - 10mm	Special mullion for 90° corner - T - cross

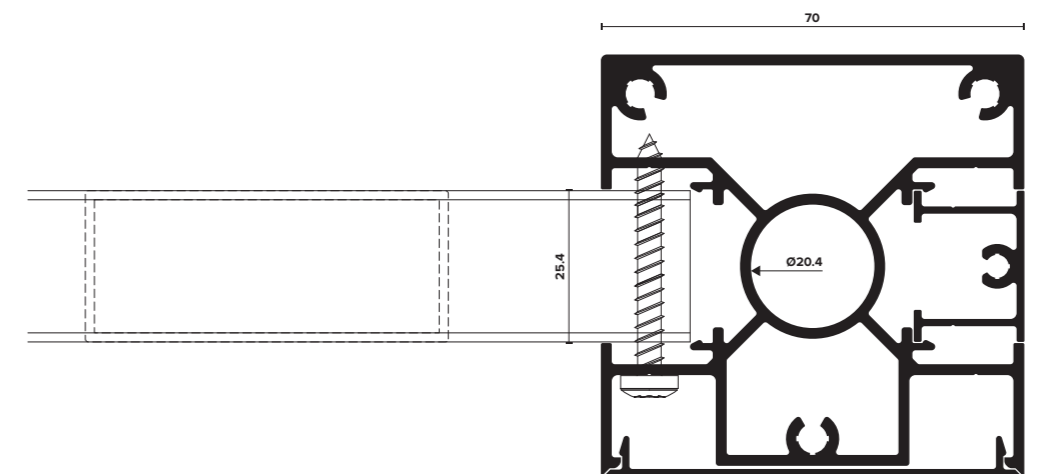

# FENCE 1

## The Typologies

---

### HORIZONTAL LOUVERS

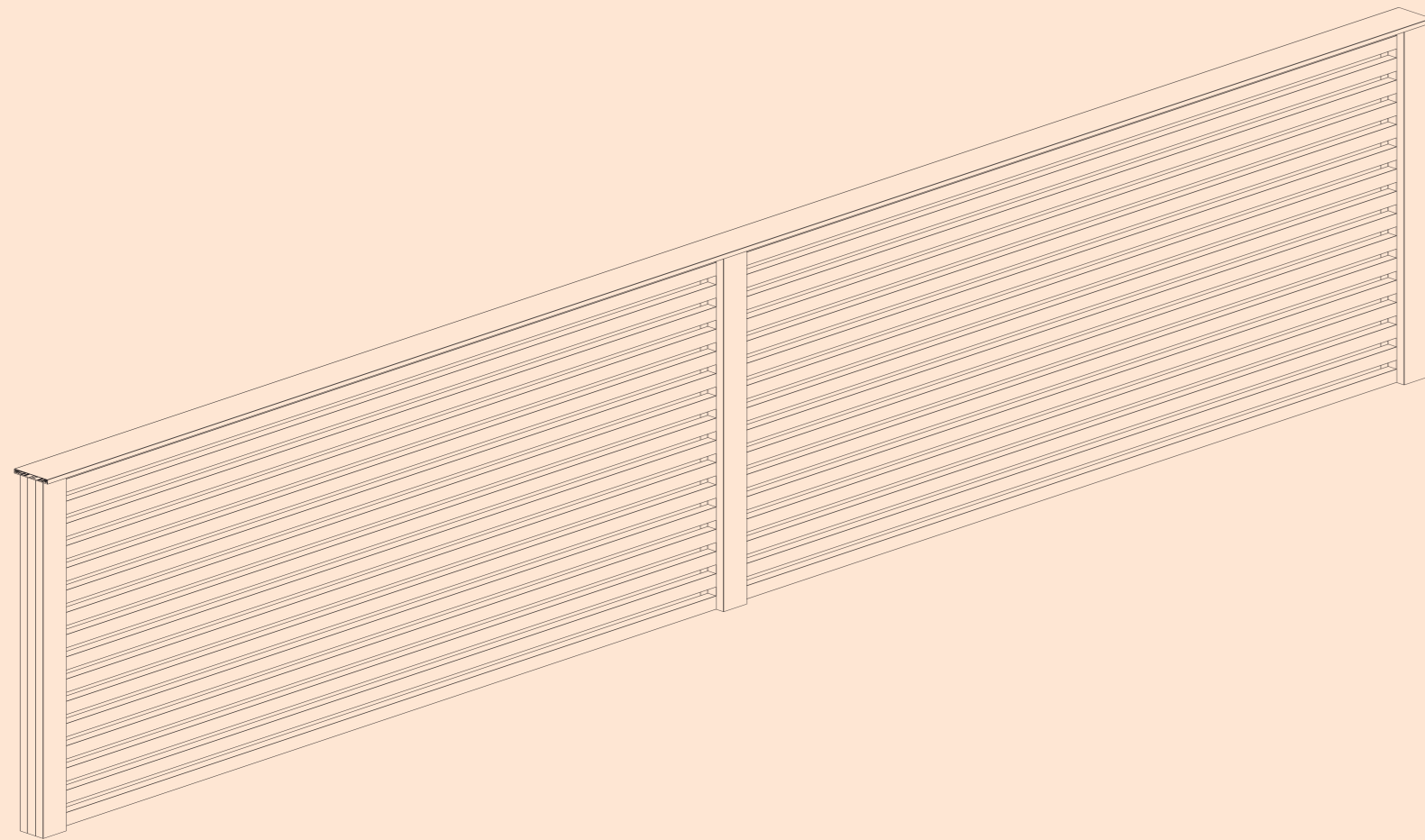

### VERTICAL LOUVERS

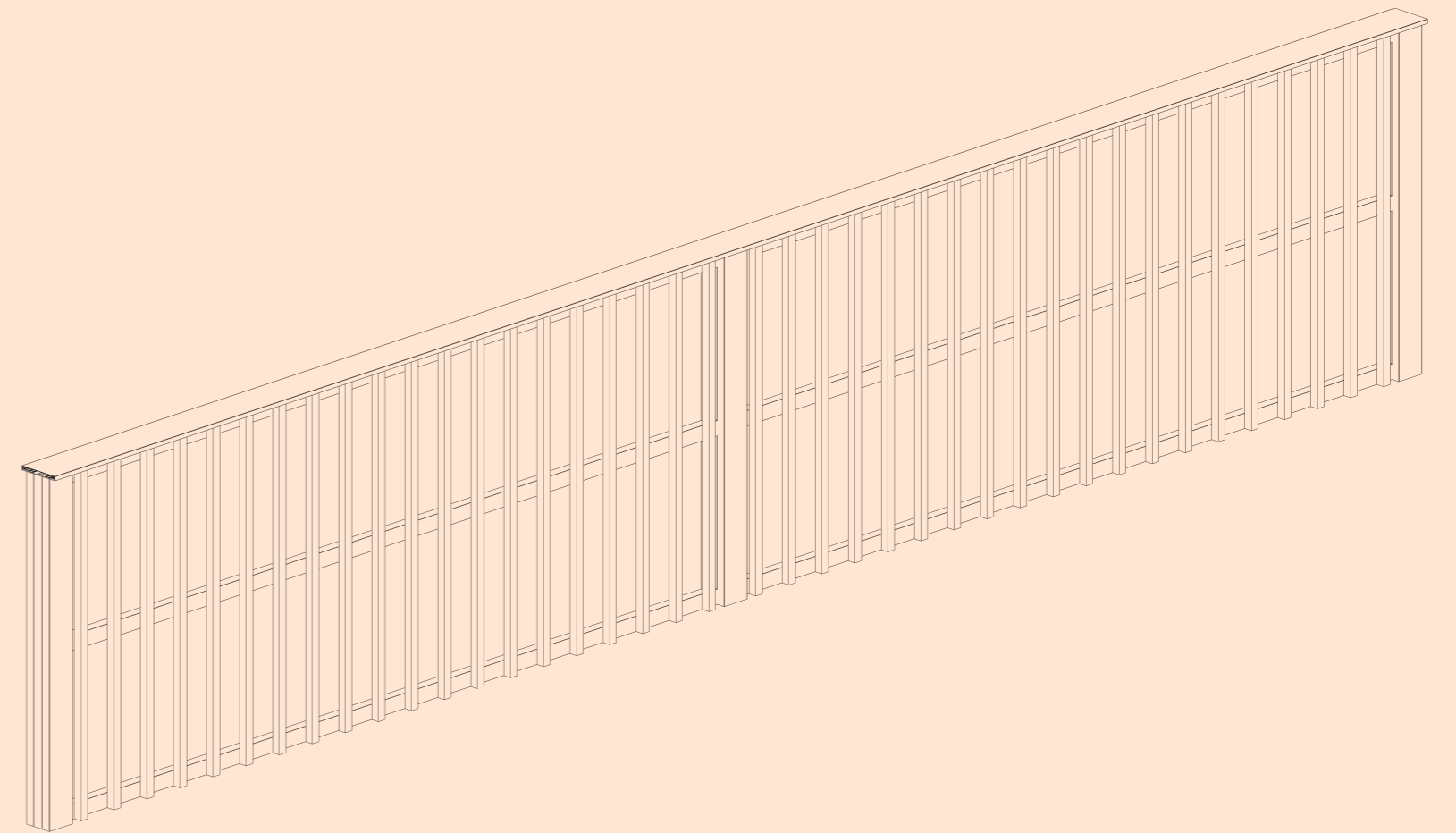



# FENCE 2

## The Identity

Mullion 70mm x 70mm	Connection with concealed screws
We first install the mullions, then the preconstructed louver frames - for fast and efficient installation	Side mounting to the frame and securing from the inner side with 4 screws
Vertical and horizontal louvers	Pin Ø20
Louvers width 25mm, 20mm and 14mm	Handrail 100mm
With an adaptor, it accepts 3mm metal sheet	Option for LED strip lighting
With an adaptor, it accepts glass with a thickness of 6mm - 10mm	Special mullion for 90° corner - T - cross

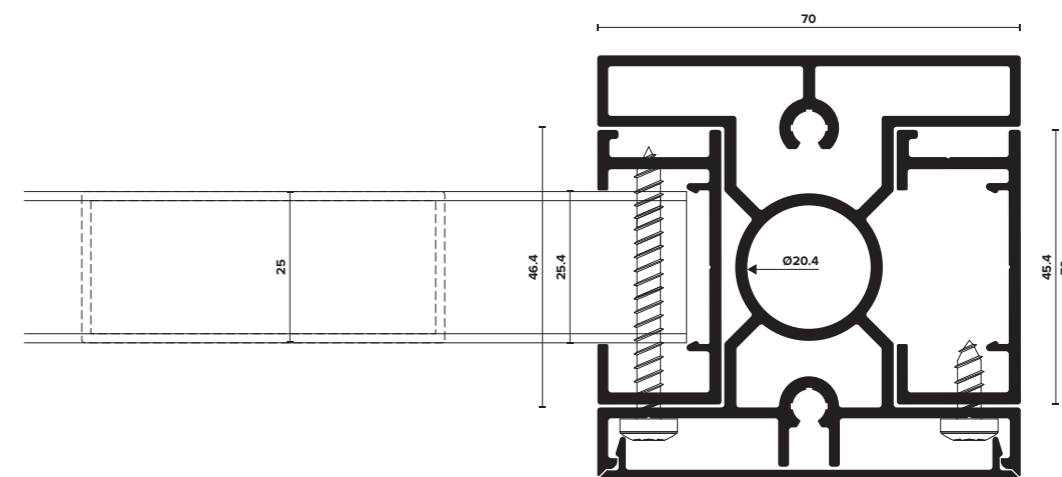

# FENCE 2

## The Typologies

---

**HORIZONTAL LOUVERS**

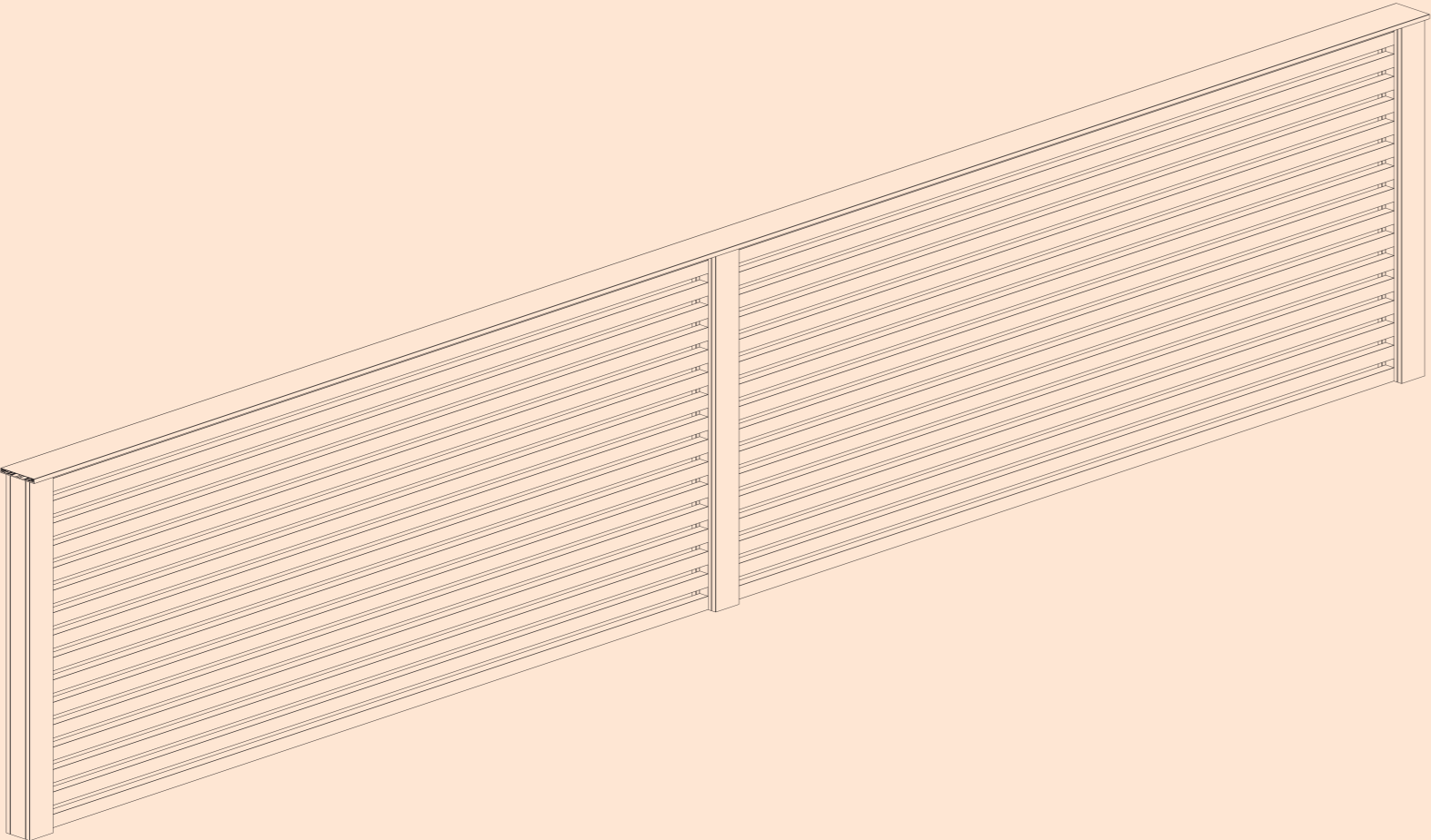

**VERTICAL LOUVERS**

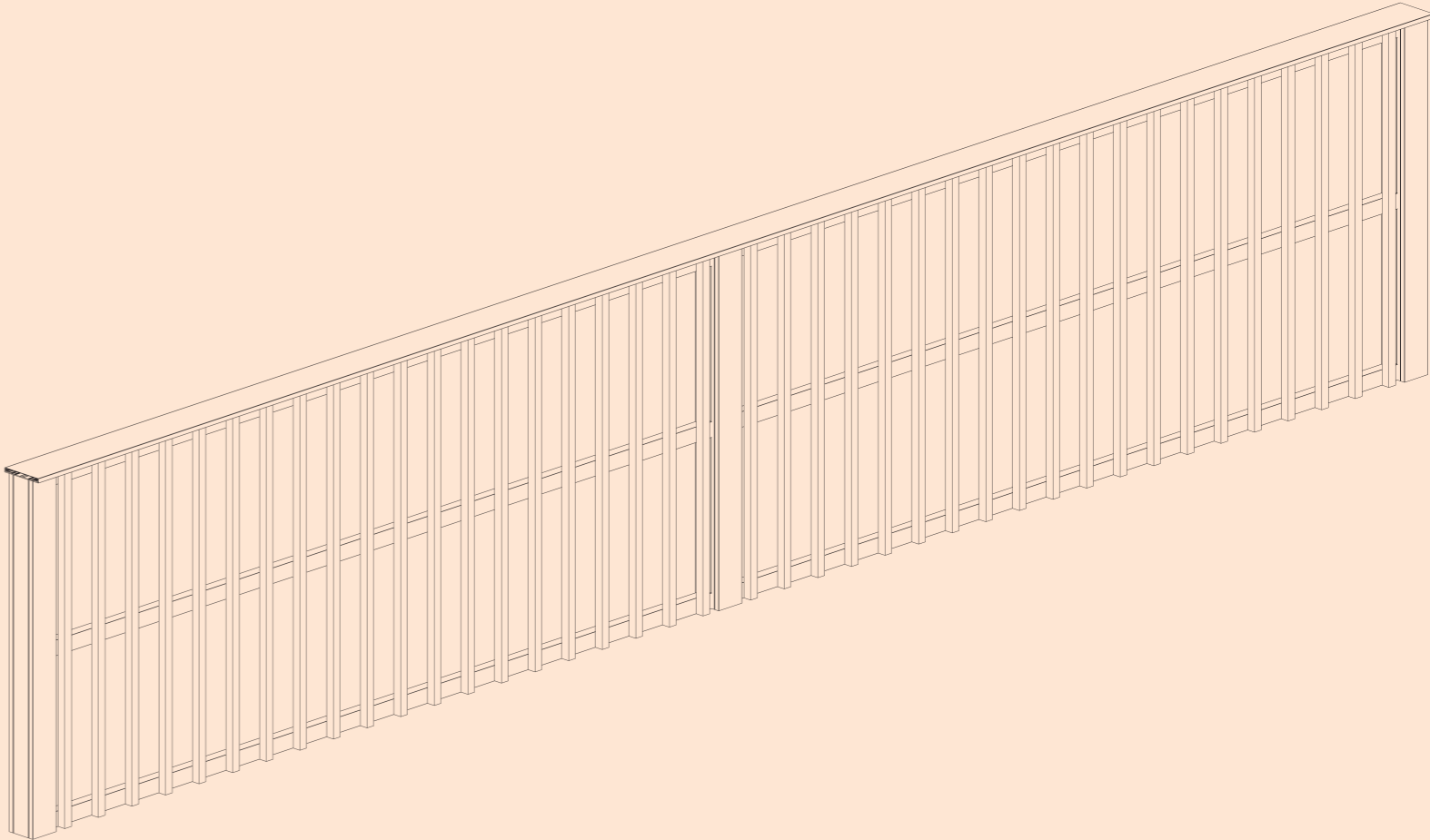



# FENCE 3

## The Identity

Mullion 60mm x 30mm	Pin Ø20
We first install the mullions, then the preconstructed louver frames - for fast and efficient installation	Handrail 100mm
Vertical and horizontal louvers. The frame embraces the mullion	Option for LED strip lighting
Louvers only with screw port, width 25mm and 14mm (horizontal ), width up to 35mm (vertical)	For 90° corner - T - cross, we use a 60mm x 60mm profile
Connection with concealed screws	
Side mounting	

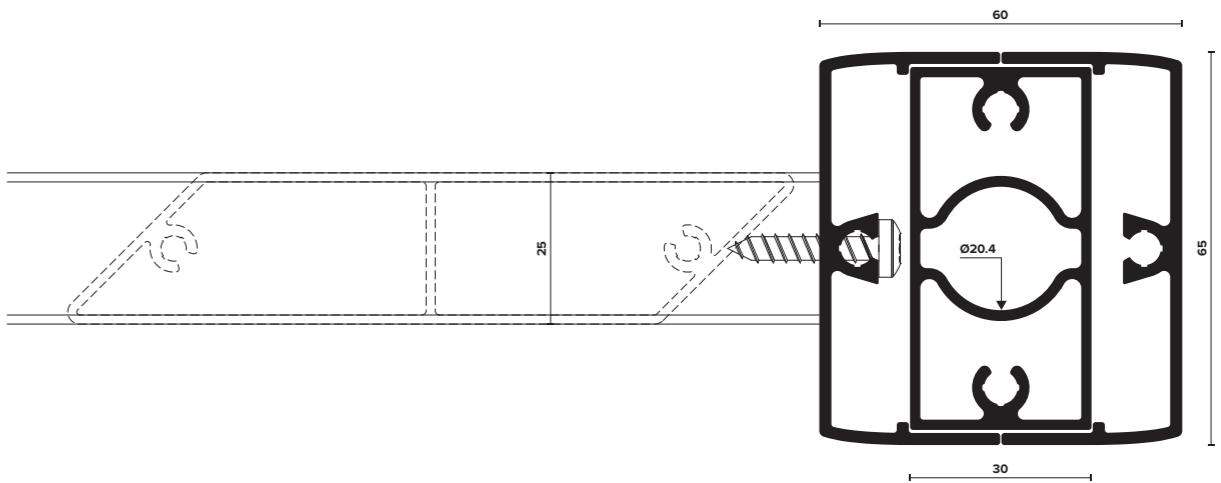

# FENCE 3

## The Typologies

---

### HORIZONTAL LOUVERS

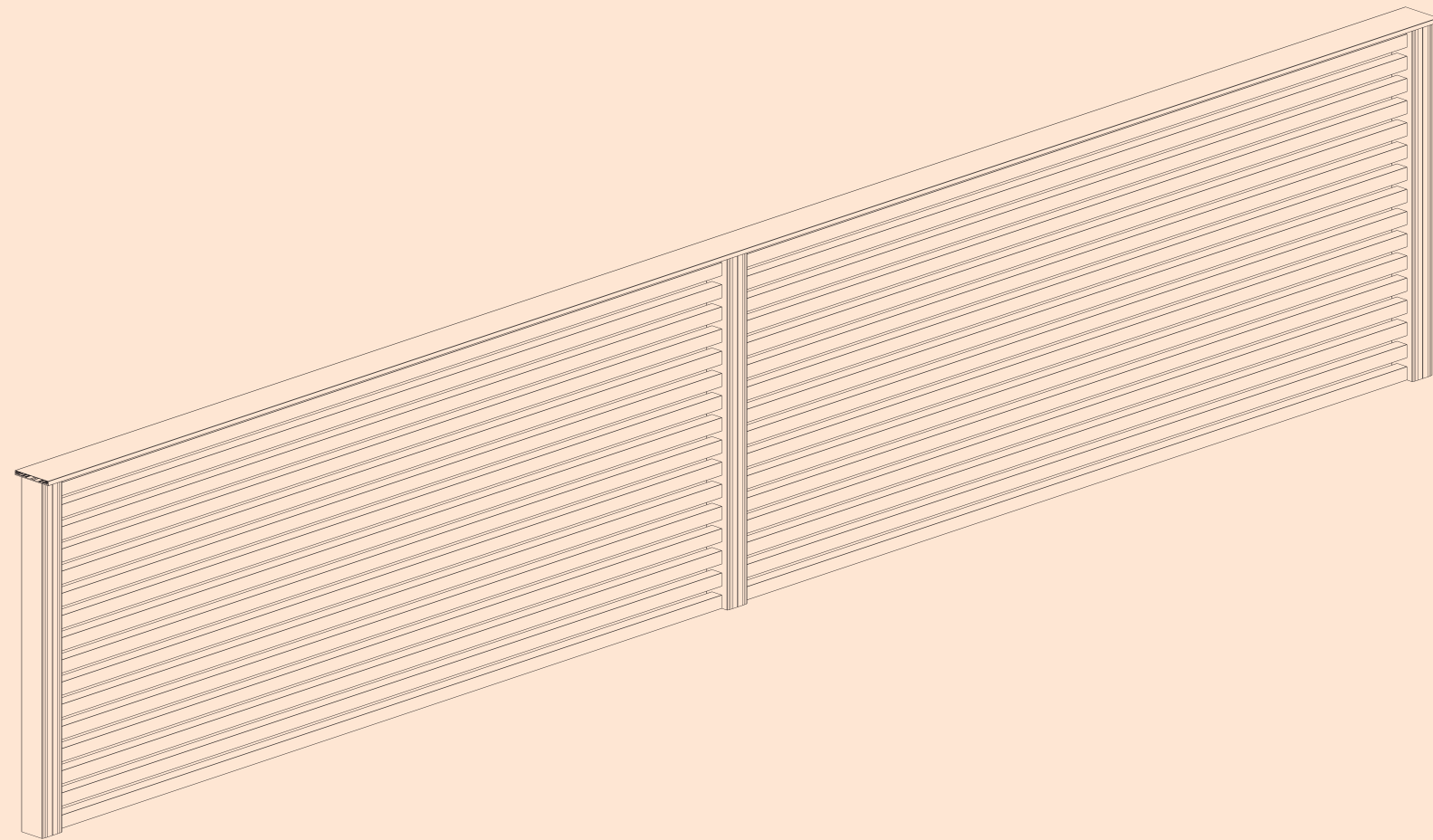

### VERTICAL LOUVERS

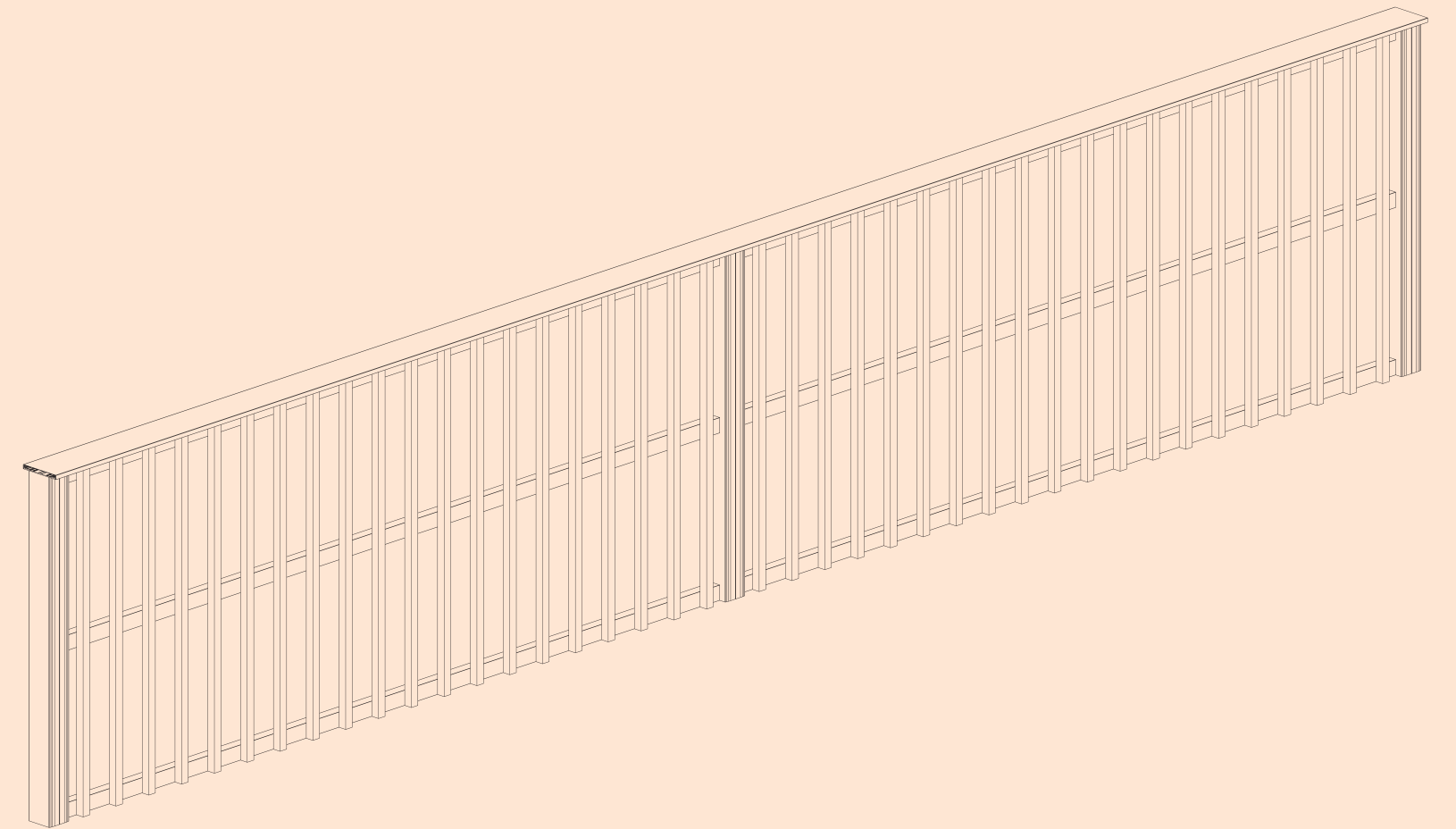

# FENCE 4

## The Identity

Mullion 70mm x 70mm (70mm x 24mm) - «T» type	Fixing from the inner side for safety
Installation louver - louver, in front of the mullions, continuous	Pin Ø20
Only horizontal louvers	Handrail 100mm
Louvers width 14mm without screw port	Option for LED strip lighting
Connection with concealed screws	Special mullion for 90° corner - T - cross

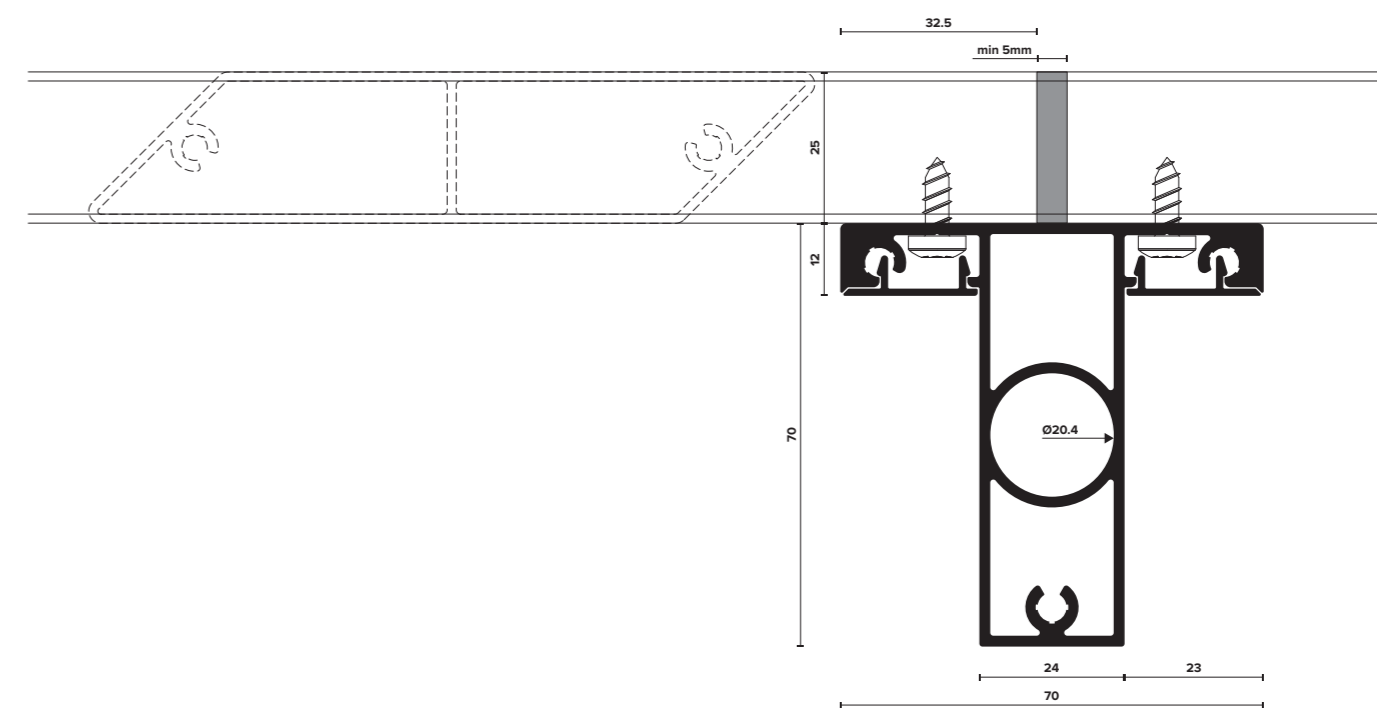

# FENCE 4

The Typologies

**HORIZONTAL LOUVERS**

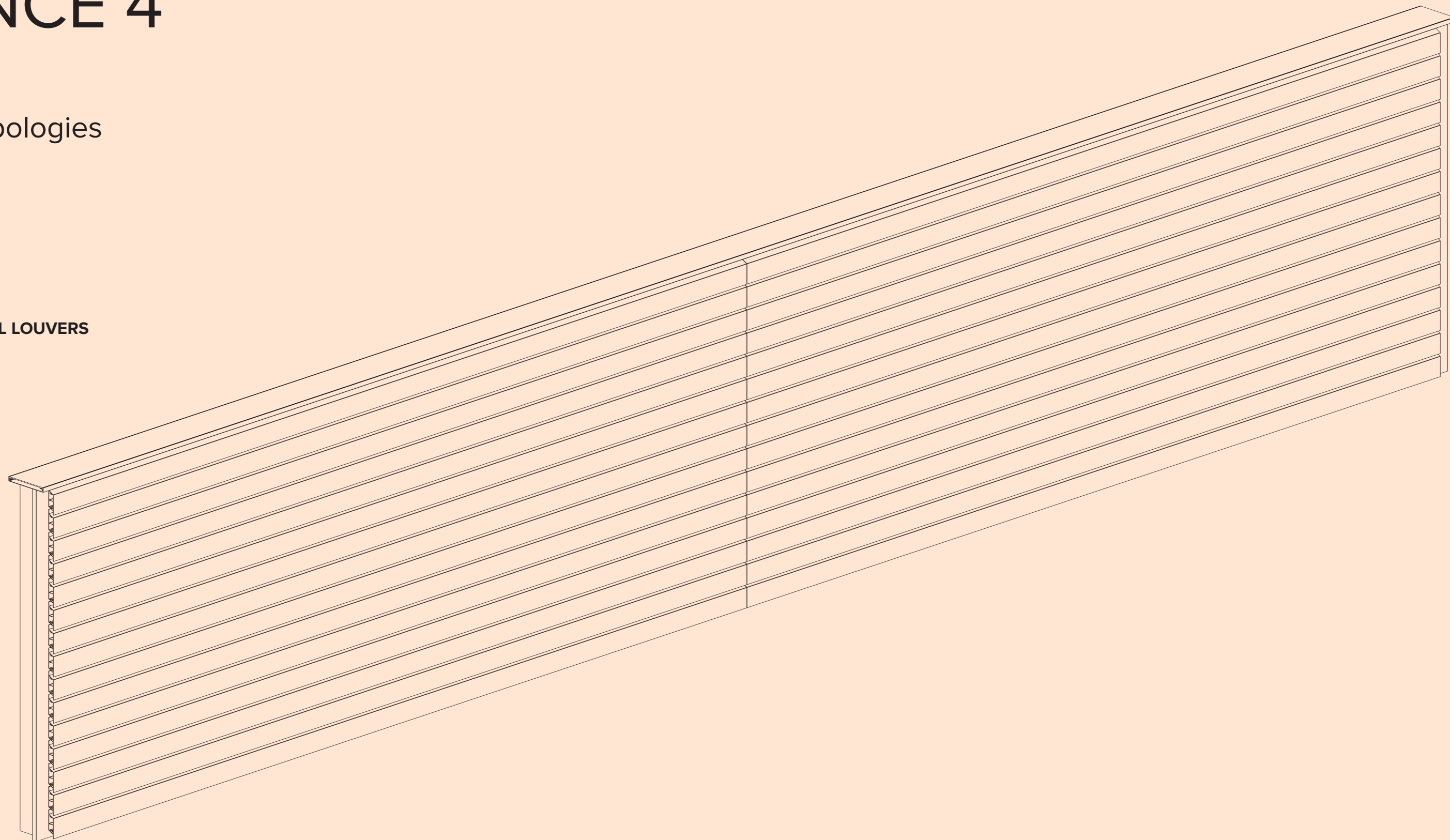



# FENCE 5

## The Identity

Base profile 100mm x 15mm

Only vertical louvers, with screw port, which are screwed onto the base profile

Louvers with a socket for Ø20 pin for concealed fastening

Handrail 100mm

Special end cap, made from machined 3mm thick flat bar, used instead of a handrail

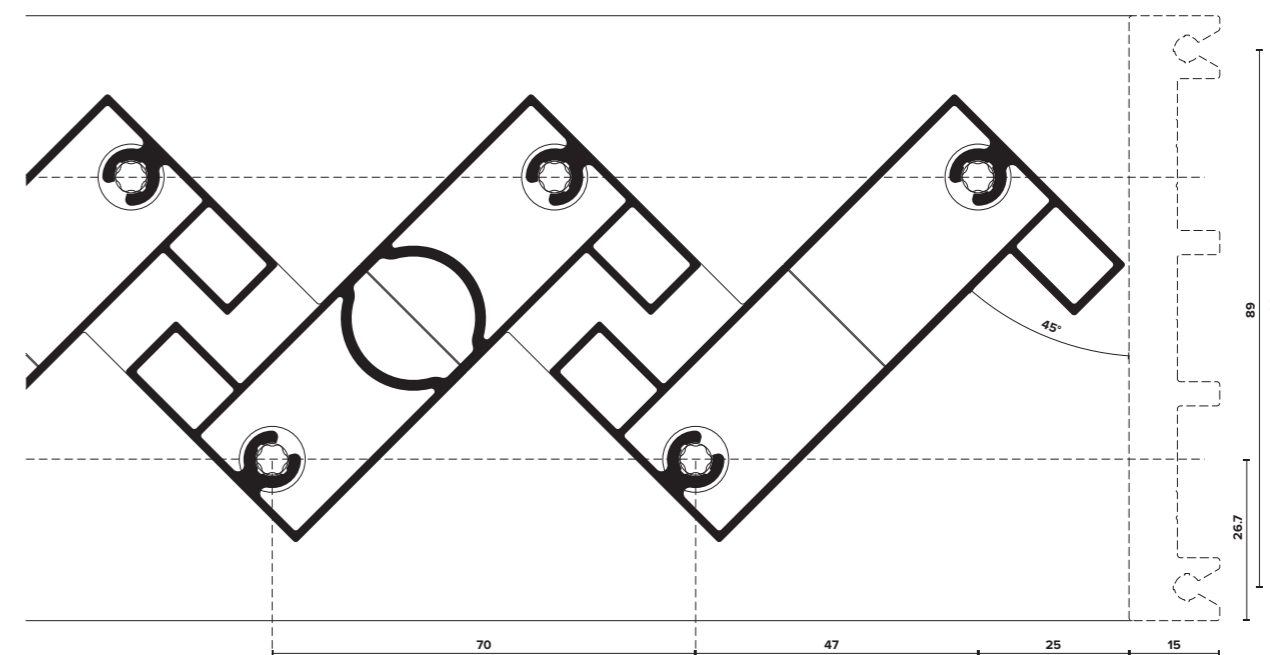



# FENCE 5

## The Typologies

---

VERTICAL LOUVERS

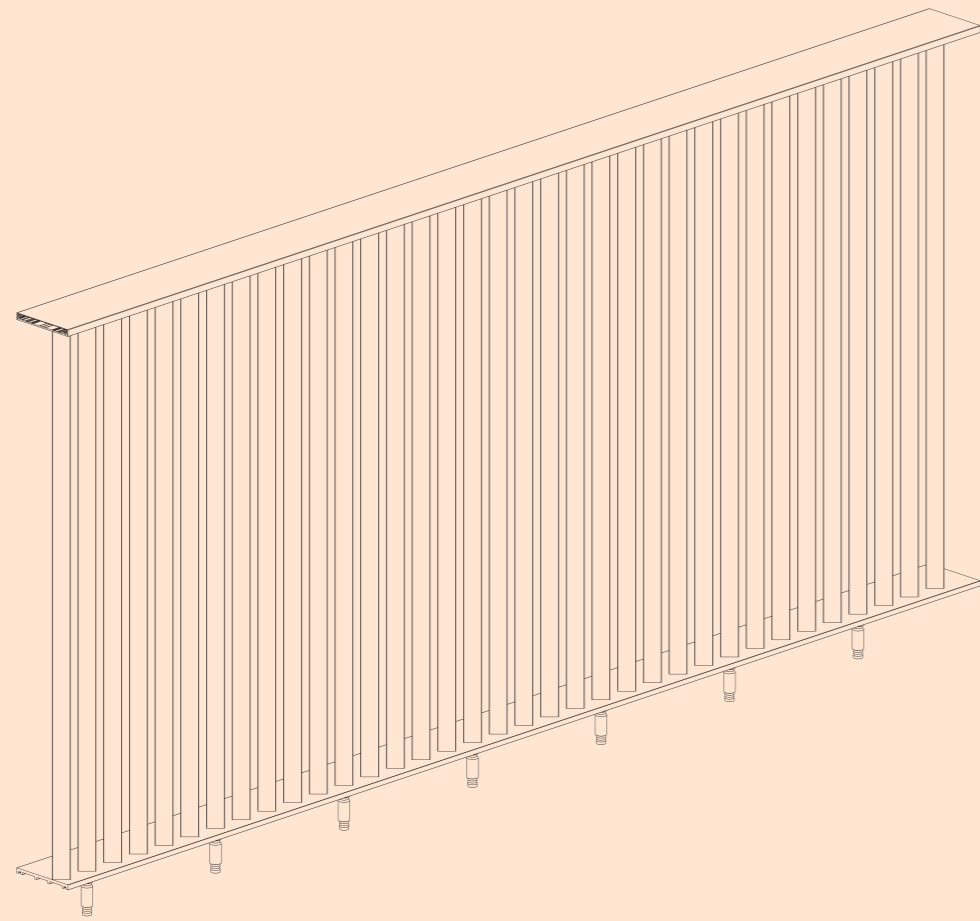

VERTICAL LOUVERS

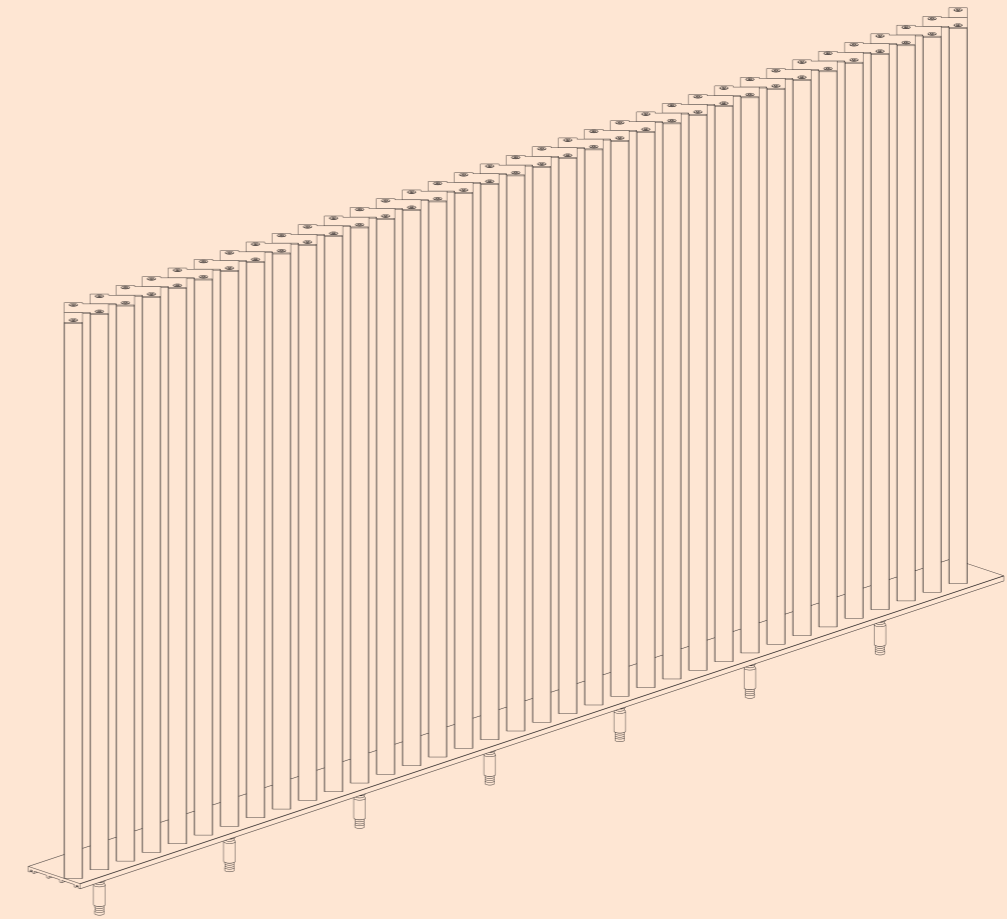

# OPENING GATES

## The Identity

Option for single or double sash gate, with inward or outward opening	90° cuttings
Vertical and horizontal louvers	Connection with concealed screws
Louvers width 25mm, 20mm and 14mm	ELVIAL hinges
With an adaptor, it accepts 3mm metal sheet	Lock 45mm
With an adaptor, it accepts glass with a thickness of 6mm - 10mm	Assembly in the manufacturing department

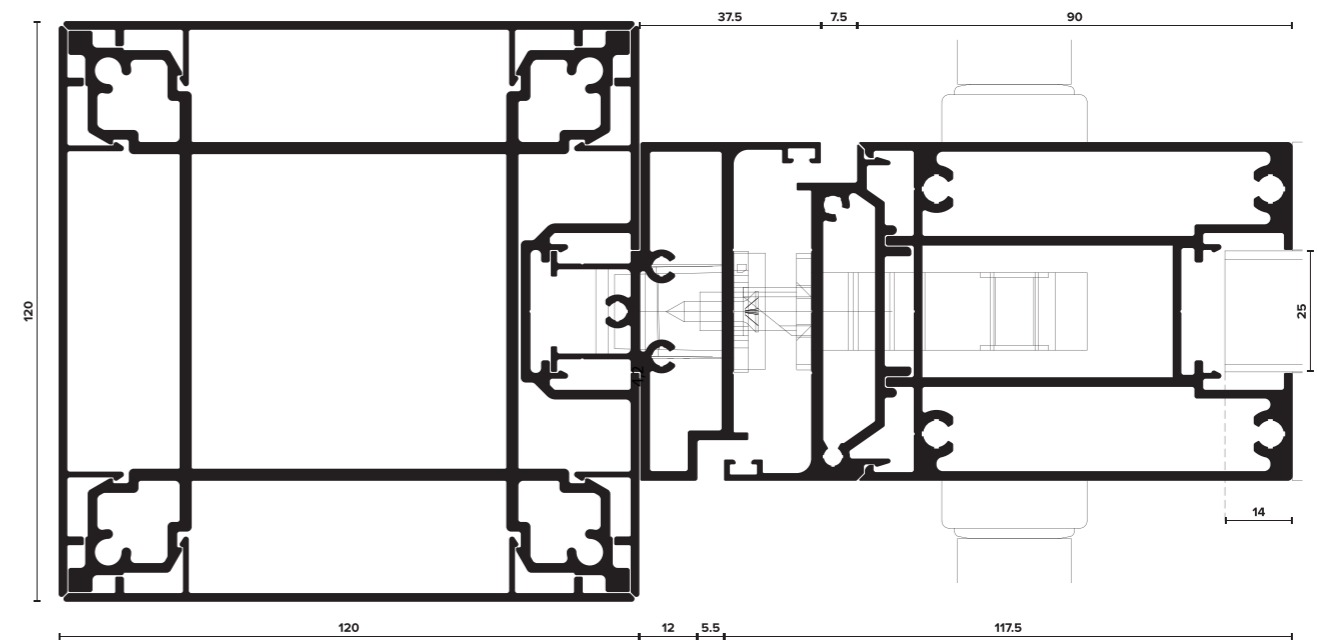

# OPENING GATES

## The Typologies

---

### HORIZONTAL LOUVERS

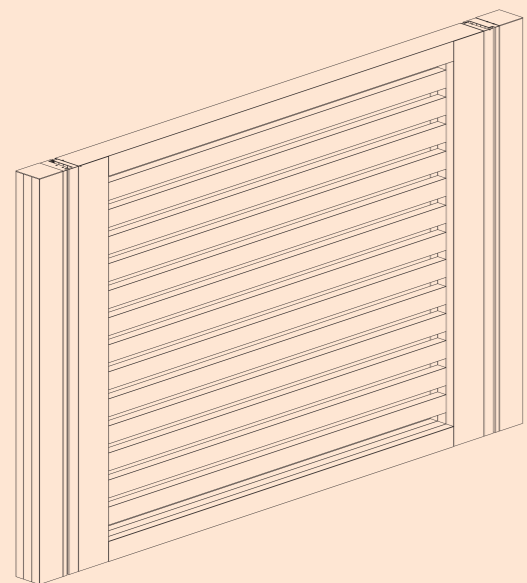

SINGLE SASH

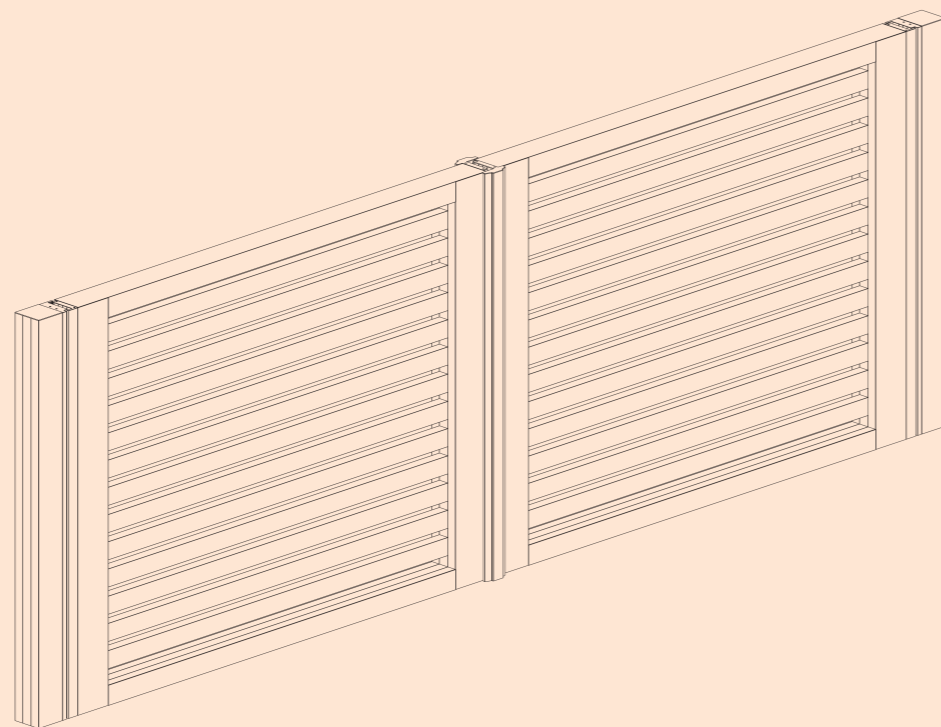

2-SASH

### VERTICAL LOUVERS

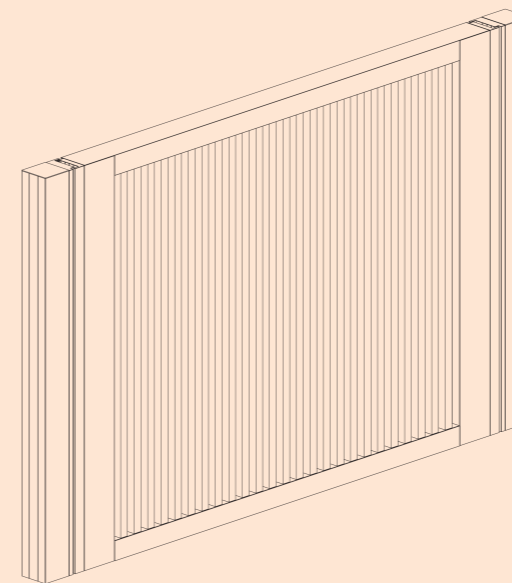

SINGLE SASH

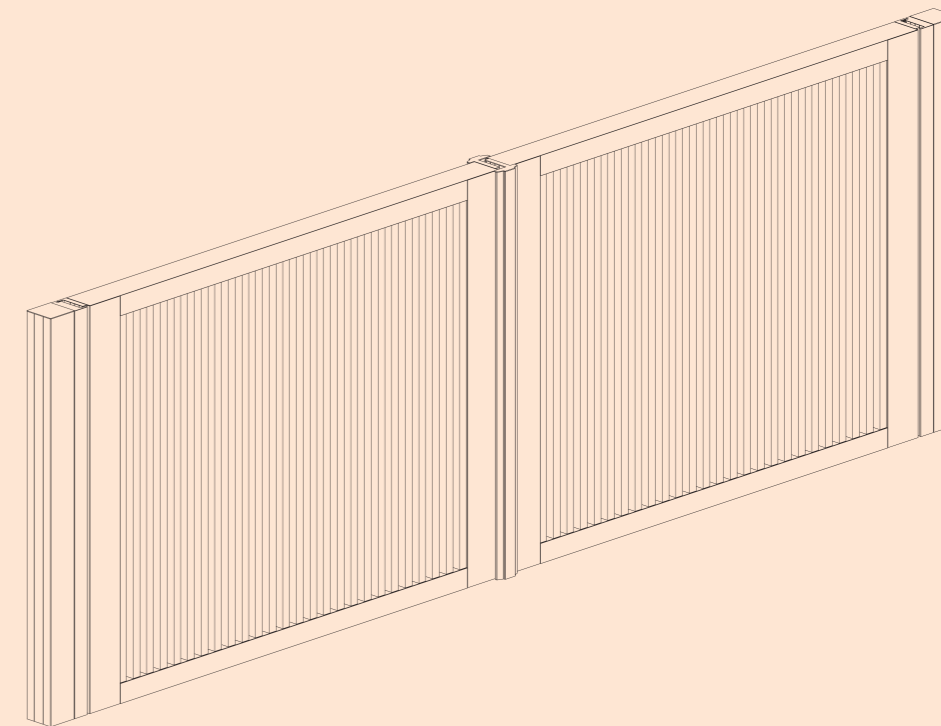

2-SASH

# SLIDING GATES

## The Identity

Vertical and horizontal louvers	90° cuttings
Louvers width 25mm, 20mm and 14mm	Connection with concealed screws
With an adaptor, it accepts 3mm metal sheet	Connection with concealed screws
With an adaptor, it accepts glass with a thickness of 6mm - 10mm	Assembly in the manufacturing department

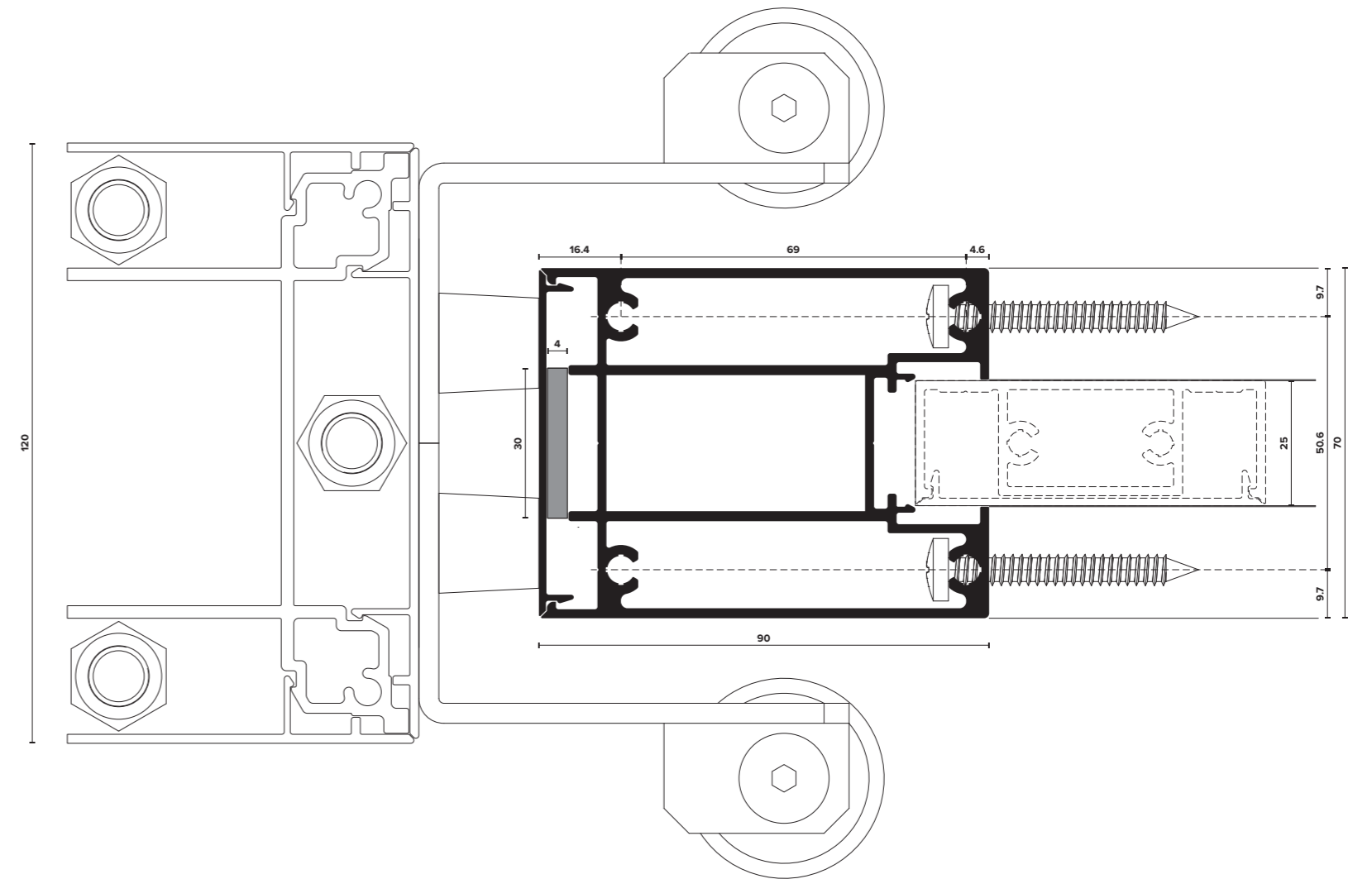

# SLIDING GATES

## The Typologies

---

### HORIZONTAL LOUVERS

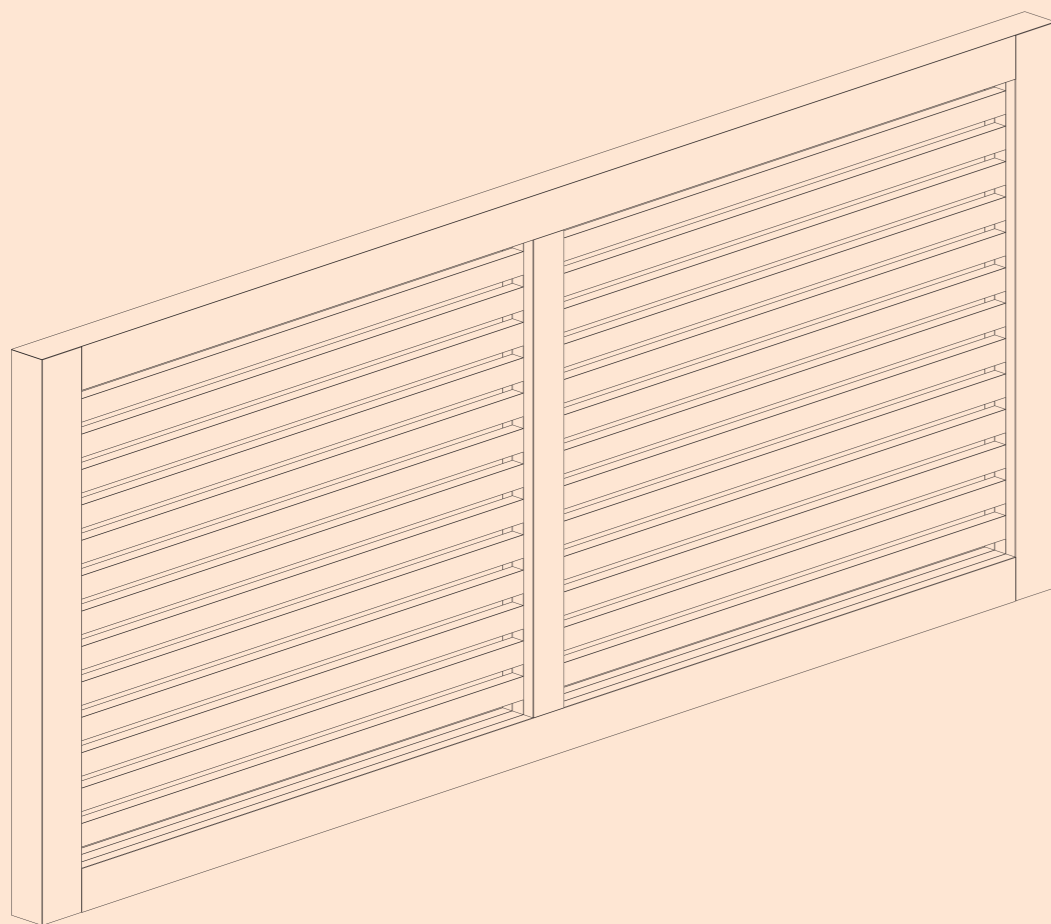

SINGLE SASH WITH FIXED T

### VERTICAL LOUVERS

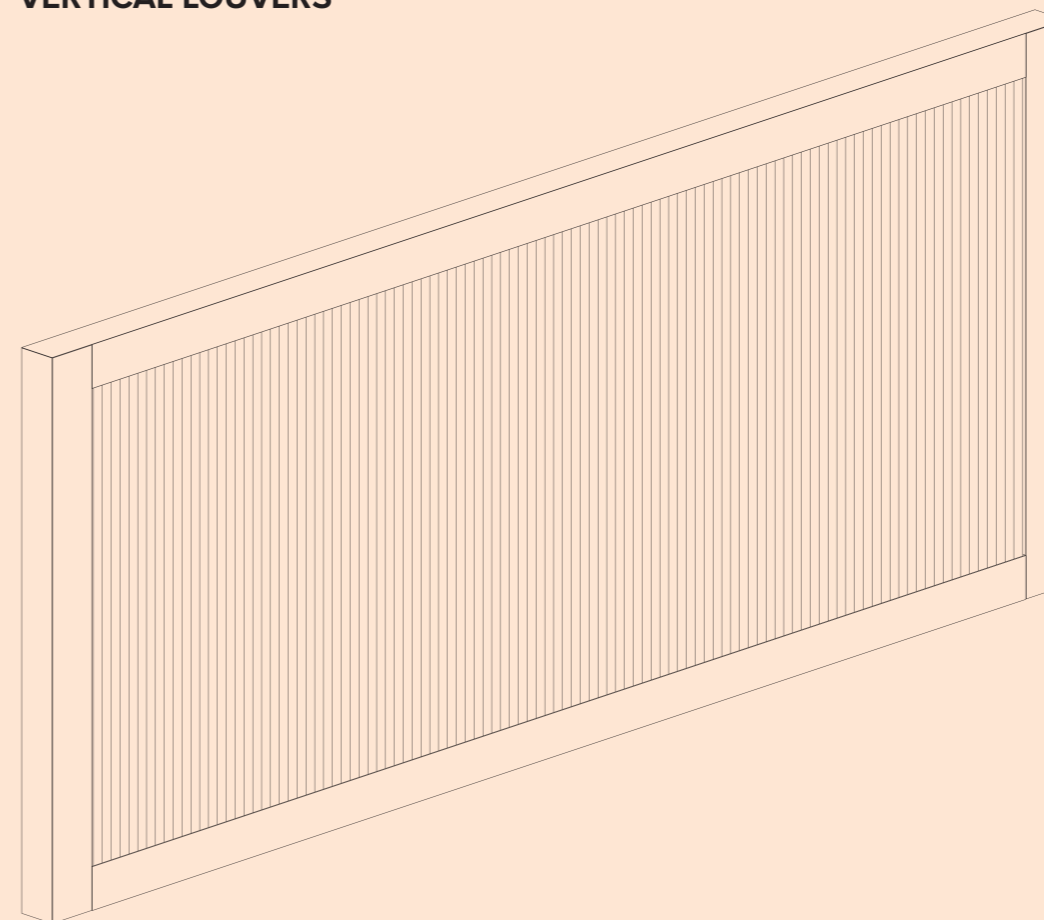

SINGLE SASH

# Extra Features.

## COLOR & DURABILITY

Accessories made from machined aluminium flat bars, 3mm thick, available in all color finishes.



## CONCEALED COMPONENTS

Form follows function, they said.  
We glorified form by concealing the functional components.

# Attention to Detail.

## LIGHT DESIGN

The specially designed profiles allow the elegant integration of LED lights.



## FULL COVERAGE

Z-shaped louvers cover the intermediate gaps, ensuring complete coverage and delivering a modern, refined result.

# THE FINISHINGS

The right choice of color may uplift the aesthetic result and add value to the building image, contributing, at the same time, to the well-being of everyday users.

There are 2 basic technologies developed for surface treatment. Powder Coating and Anodizing.

But if you want to achieve the ultimate combination of these 2 methods the solution is given by Pre-anodizing.



**STRONGER THAN TIME.  
STRONGER THAN ELEMENTS.**

## ELVIAL PRE-ANODIZING 2IN1

- // Zero waiting time
- // Spotless environment
- // Robotic handling

**THIS IS WHAT  
ELVIAL PRE-ANODIZING 2IN1  
is all about.**

**ELVIAL owns the first in Greece and one out of seven worldwide, fully automated serial pre-anodizing and powder coating lines according to Qualicoat standards and has been received the SEASIDE (PRE-OX) label, following successful laboratory testing and inspections.**

ELVIAL Pre-Anodizing 2in1 facility is robotic. No human hand meddles with the materials; the production environment is free of dust and other aggravating factors.

The profiles are subdued to an electrochemical procedure identical to that of anodizing. The aluminium profiles are placed in an underground tunnel and submerged in a sulfuric acid solution.

Pre-anodizing produces an anodic substrate on the surface of the aluminium profile that protects it from corrosion. Then the profiles are serially painted, eliminating waiting time, whilst the pores on the aluminium surface of the profile are completely sealed.

Pre-anodizing 2IN1 from ELVIAL is uniquely combined with Class 2 [Super Durable] powder coatings.

**INNOVATIVE TECHNOLOGIES\_  
ELVIAL PRE-ANODIZING 2IN1\_  
ELVIAL I<sup>2</sup> INSULATION TECHNOLOGY\_  
ELVIAL WINDOW.ID\_  
BE DIFFERENT.**

**elvial**

**elvial.com**

While every effort has been made to ensure information accuracy,  
ELVIAL bears no responsibility for typographic errors or omissions.  
Photographs may differ from the actual product.  
This document is subject to change without prior notice.  
Copyright © ELVIAL 2026 G.EM.I 014493035000